

LightSweep™

Modular Lighting Control System CLCDLS

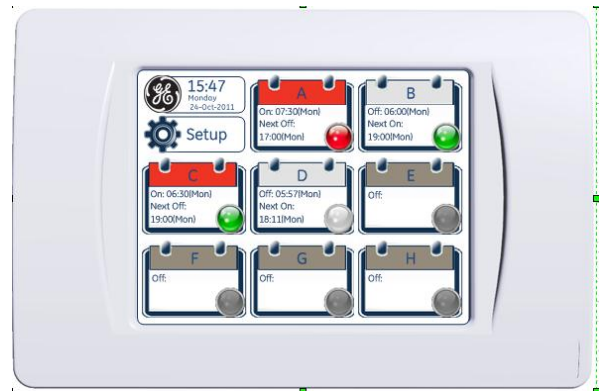

Description

The **CLCDLS** touch screen Scheduler provides 8 schedules to control any relays or groups in the lighting system. It also provides astronomical clock information, calculating sunrise and sunset times based on UTC and location. 8 additional lighting control groups are available for Common Area control or other grouping needs.

The device is powered off the same structured cabling which powers the **CLCSWTx** Network Switches, and provides a user interface into the network for configuring any device in the network independent of where it is located.

Features

- 3.5" Full Color Touchscreen
- 8 weekly schedules with up to 8 durations per day
- Single or recurring exceptions to each schedule
- Real time clock with Super-cap backup
- Configuration interface for entire lighting network
- Astronomical clock functionality
- 8 additional programmable groups
- Communicating and powered from CAN lighting network

Application

The **CLCDLS** can turn On and/or Off up to 60 individual relays or lighting control groups for each schedule, with scheduling exceptions or astro functionality. Any lighting control group in the network may enable or disable functionality based on time of day by subscribing to any schedule.

The dataline scheduler doubles as a user interface into the lighting network allowing the user to configure, edit and operate all switches, sensors, relays and remote schedules in the system. It can be mounted in the LCP or on a standard electrical wall box for mounting in the space. Each **CLCDLS** adds 8 schedules to the system, providing scalability for any advanced lighting application scenarios.

Ordering

Order the controller and desired options with the following product numbers:

CLCDLS - Touchscreen Dataline Scheduler

Specifications

Technology

32-bit ARM Processor with internal A/D, Flash and RAM

Communications Port

CAN Network @40k bps

Device Address

Set via touchscreen
Address range: 1 to 99

Connectors

Network/Power: (2) RJ45

Wiring Class

Class 2

Power

24 VDC
3 VA

Ambient

32° to 131°F (0° to 55°C),
with enclosure 10-90% RH
(non-condensing)

Dimensions

5 x 3 1/4 x 1 1/4 in.
(12.7 x 8.3 x 2.6 cm) with housing
0.34 lb. (155g) with housing

Compliance

CE
FCC

Approvals/Standards

cUL Listed - Energy Management

Information provided is subject to change without notice. Please verify all details with GE. All values are design or typical values when measured under laboratory conditions, and GE makes no warranty or guarantee, express or implied, that such performance will be obtained under end-use conditions.